

CAS

*“ DB-II (DBB) ”*

*[ Bench Scale ]*

2006. 10. 24  
Marketing Division

**BEYOND THE GLOBAL**



## Certificates

BEYOND THE GLOBAL

We have  
**CE / OIML / EC**  
type  
Approval  
Certificates

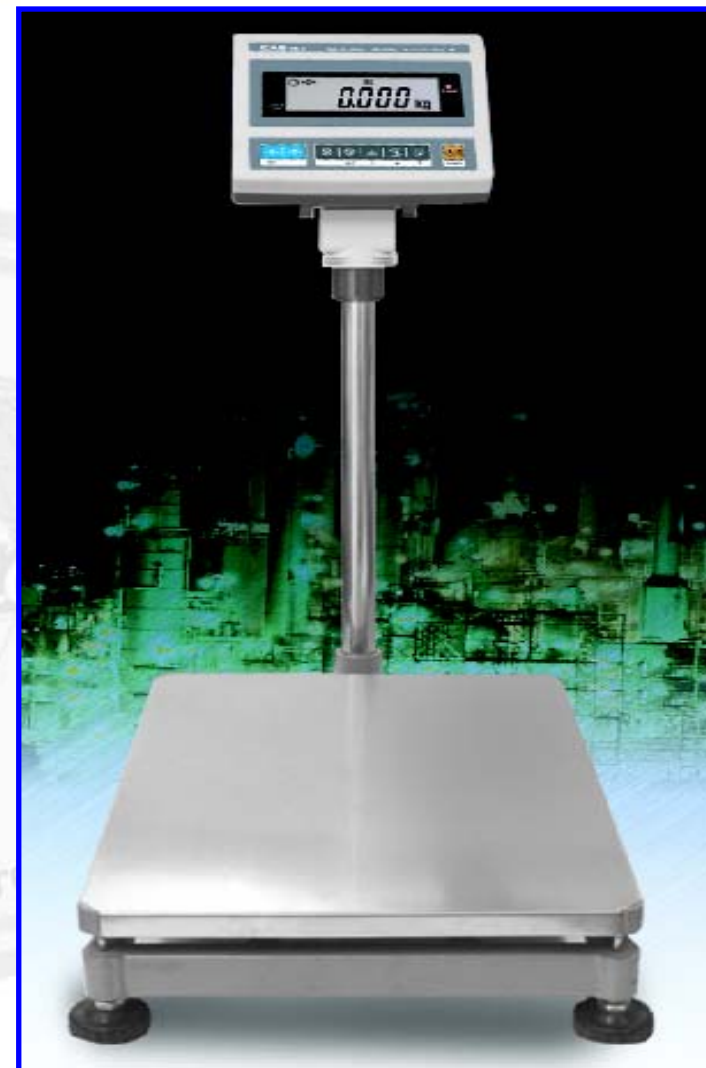

CAS

## New standard features:

- RS 232C for printer connection: DEP printer
- Tilt & Pivoting indicator
- Increased weighing capacity up to 300 kg (OIML upto 150kg)
- LCD display
- User friendly icon keyboard

## Options:

- Back Light(E/L)
- R/Charge Battery
- Wall type indicator



We added new functions and created more flexible scale

Main Functions :

- General Weighing
- Weighing with Tare
- Counting Mode
- Percent Weighing Mode
- Hold Function
- Cumulative Weight Sum
- Print Function







*Body ass'y*

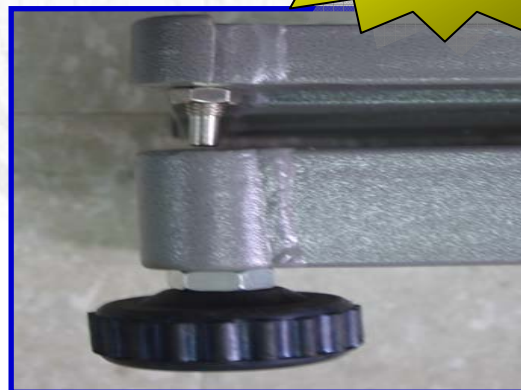



*Body ass'y*





*Carton box ass'y*







**New!**

*Tilt bracket ass'y  
for DBB indicator*



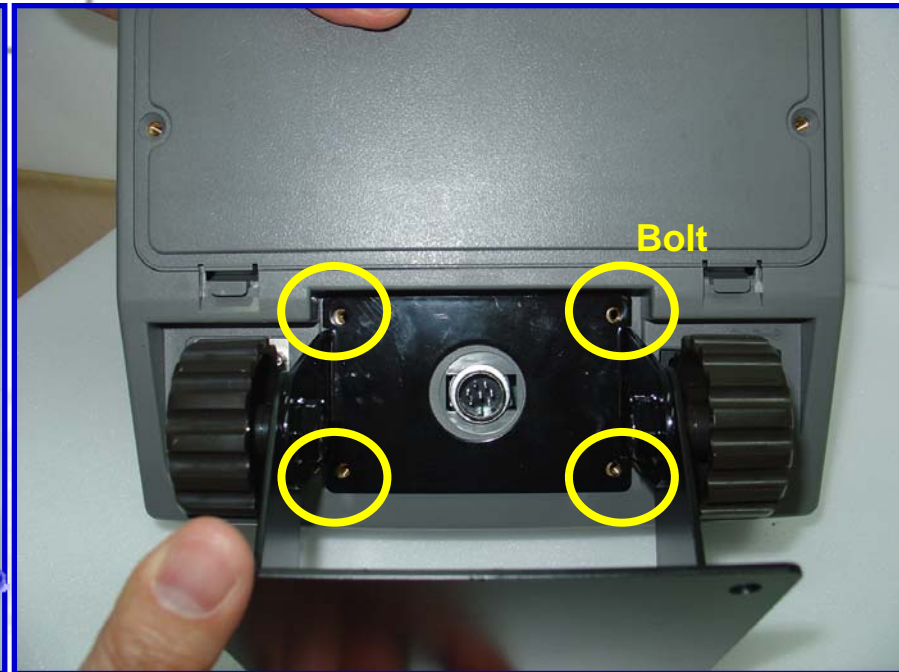

\* Load Cell Connector type(▼)



**DBB Indicator (Head ass'y)**

- AC Adaptor
- Rechargeable battery type
- Counting, Limit function
- Back light



**New!**

*Tilt bracket ass'y  
for DBB indicator*



# Ticket Printer



## Cumulative Weight Sum Function

```

===== WEIGHT =====
WELCOME TO CAS[DB-2] CAS
      2002-09-30 17:55:30
Weight:      40.180 kg
Weight:      40.200 kg
Weight:      40.200 kg
Weight:      40.200 kg
Weight:      40.200 kg
Weight:      40.200 kg
Weight:      40.200 kg
Weight:      40.200 kg
Weight:      40.200 kg
Weight:      40.200 kg
-----
Total:      401.980 kg
Count::      10 times
    
```

## Counting Function

```

===== WEIGHT =====
WELCOME TO CAS[DB-2] CAS
      2002-09-30 16:55:30
Weight:      40.200 kg
U/Weight:    0.80400 kg
Quantity:    50 pcs

-COUNT LIMIT SET VALUE -
Limit(H):    2000 pcs
Limit(L):    1000 pcs
    
```

## Weighing Function

```

===== WEIGHT =====
WELCOME TO CAS[DB-2] CAS
      2002-09-30 16:50:30
Weight:      25.000 kg

-WEIGHT LIMIT SET VALUE -
Limit(H):    40.000 kg
Limit(L):    30.000 kg
    
```



# Specifications

BEYOND THE GLOBAL

MODEL	DBB-Jr. 60kg/150kg		DBB-Jr. 60kg /150kg/300kg		
Capacity	30kg/10g 60kg/20g	60kg/20g 150kg/50g	30kg/10g 60kg/20g	60kg/20g 150kg/50g	150kg/50g 300kg/100g
Internal Resolution	1/30,000				
External Resolution	1/3,000(dual interval)				
Display	6 digits (LCD)				
Display Lamps	STABLE, ZERO, HOLD, NET, HI/ OK/ LO, %, PCS, SUM, kg, lb, oz,Low Battery				
Max. Tare	Full tare				
Power Source	AC Adapter 9V/850mA 6V 3.3Ah 20hr Pb Battery				
Battery Life	Approximately 100 hours with back light off				
Platter size (mm)	360(W) x 460(D)		460(W) x 570(D)		
Product size (mm)	360(W) x 580(D) x 765(H)		460(W) x 690(D) x 765(H)		
Packing size(mm <sup>3</sup> )	810(W) x 510(D) x 150(H)		910(W) x510(D) x150(H)		
Product Weight (kg)	12.30		19.65		
Temperature(°C)	-10°C ~+40°C				
Interface	RS-232C				
Options	Back Light				

※ EC Type Approval : Single interval

CAS